

# Emergency stop rope pull switches

## Preventa XY2C

Catalogue



**Telemecanique**  
**Sensors**



# Emergency stop rope pull switches Preventa XY2C

## ■ Emergency stop rope pull switches Preventa XY2C

□ General . . . . .	pages 2 to 4
□ Characteristics . . . . .	page 5
□ References . . . . .	page 6
□ XY2CH order form . . . . .	page 7
□ XY2CE order form . . . . .	page 8
□ Separate components references . . . . .	page 9
□ Mounting accessories and kits references . . . . .	page 9
□ Replacement parts references . . . . .	page 10
□ Dimensions . . . . .	page 11

## ■ Rope pull switches Preventa XY2CB

□ Characteristics . . . . .	page 12
□ Rope pull switches references . . . . .	page 13
□ Separate components and replacement parts references . . . . .	page 14
□ Dimensions . . . . .	page 15

## ■ Product reference index . . . . .page 16

# Safety detection solutions

## Emergency stop rope pull switches

### Preventa XY2C

#### Presentation

##### Emergency stop rope pull switches

Emergency stop rope pull switches are designed to:

- avert hazards (dangerous phenomena) at the earliest possible moment, or to reduce risks which could cause injury to persons or damage either to machines or work in progress,
- be tripped by a single human action when a normal Emergency stop function is not available,
- trip in the event of the rope pull breaking.

Emergency stop rope pull switches are essential in premises and on machines that are potentially dangerous when in operation. The operator must be able to trigger the stop instruction at any point within their working area.

**Application examples:** woodworking machines, shears, conveyor systems, transfer machines, printing machines, textile machines, rolling mills, test laboratories, paint shops, surface treatment works.

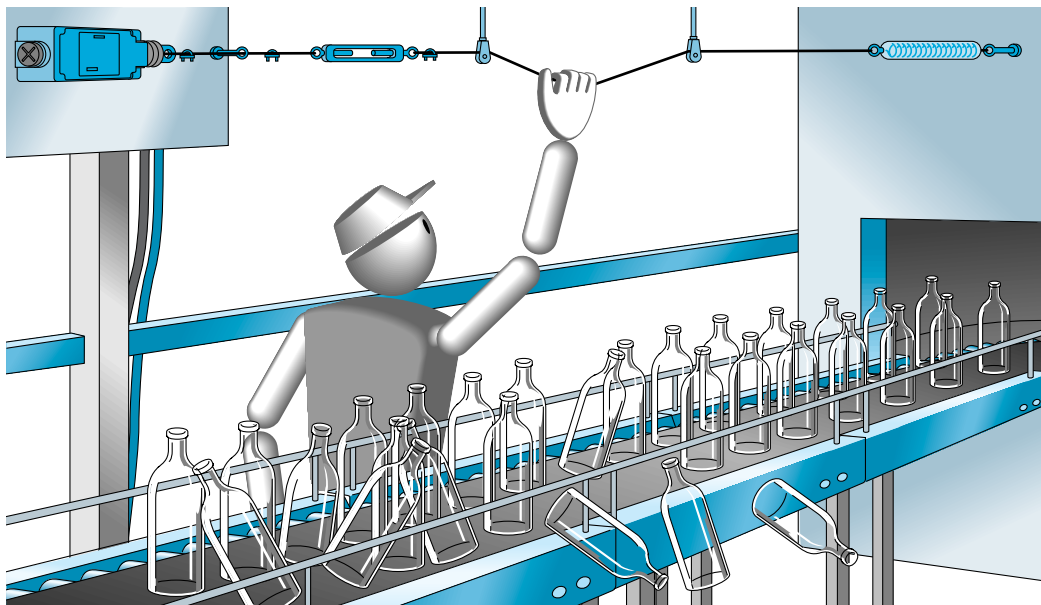

#### Installation

##### Typical installation

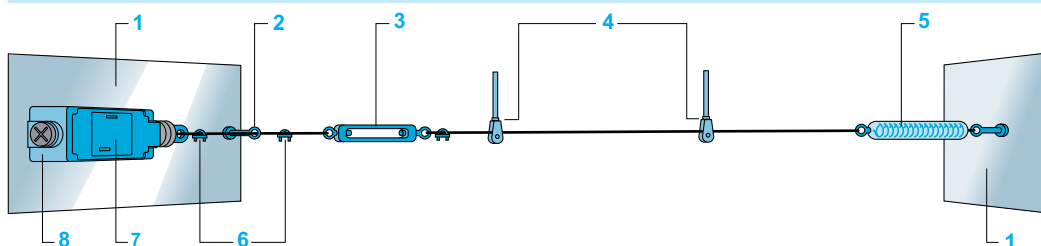

- |                       |                               |                     |
|-----------------------|-------------------------------|---------------------|
| 1 Fixing support      | 4 Pulley supports and pulleys | 7 Switch adjustment |
| 2 First cable support | 5 End spring                  | 8 Emergency stop    |
| 3 Turnbuckle          | 6 Cable grips                 |                     |

##### Notes regarding installation

- All XY2CH and XY2CE emergency stop rope pull switches can be fitted with a pilot light to indicate their tripped condition.
- Cable tension adjustment can be performed using:
  - a turnbuckle (to be ordered separately, see page 9),
  - a tensioner (integrated in certain XY2CH models, see page 9).
- This adjustment is simplified by:
  - a cable tension indicator that is available on all models XY2CH,
  - the availability of versions with a "cable tension indicator" window by stating its reference on the order form (see page 8). Example: reference XY2CE1A250 becomes XY2CE1D250.
- The use of an end spring is strongly advised for conveyor system applications to ensure operation of the Emergency stop in the event of the cable being pulled towards the switch.
- It is essential that pulleys be used with ropes pull that deviate from a straight run, i.e. angled to form a protected zone.
- Important: emergency stop rope pull switches XY2CH and XY2CE can be used if the installation requires that the rope pull be angled. In this case, the total sum of the angles through which the rope pull bends must not exceed 180°. (For further information on instructions to be adhered to, please refer to the installation manual).

# Safety detection solutions

## Emergency stop rope pull switches, Preventa XY2C

### Main features

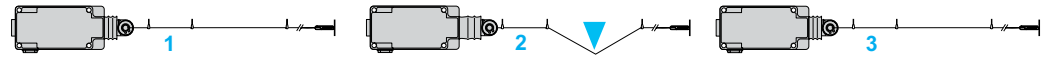

**Positive operation:** running condition

**Latching:** stop instruction given (tripped)

**Resetting:** stop condition (awaiting reset/restart)

**1** The switches incorporate positive opening operation contacts, the tripping of the switch being made with positive action.

**2** The switch latches in the tripped position (NC safety contact(s) open). The function of the NO contact is purely for signalling.

**3** The switches incorporate a reset button, which re-closes the safety contact(s). Restarting of the machine must only be achieved by manual operation of a control device within the machine start circuit, remote to the emergency stop rope pull switches.

### Rope pull expansion and contraction: d

Temperature variations likely to be encountered in the protected zone will obviously cause the rope pull to expand or contract. To enable instant verification that the rope pull is at its correct tension (and for making any necessary adjustments), emergency stop rope pull switches XY2CH and XY2CE incorporate a rope pull tension indicator.

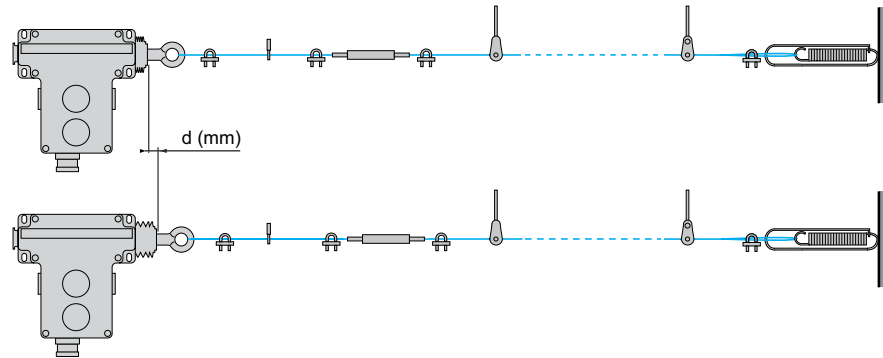

### Standards

Emergency stop rope pull switches Preventa XY2CH and XY2CE meet all the requirements of the harmonised European standard **EN/ISO 13850**, relating to Emergency stop devices. All the emergency stop rope pull switches are **CE** marked and supplied with an EC declaration of conformity.

### Cable's diameter

In order to achieve the maximum cable length, according to ambient temperature variation, we recommend to use :

- galvanised cables with red sheath diameter 3.2 mm for XY2CH range and
- galvanised cables with red sheath diameter 5 mm for XY2CE range (see page 9).

Adjustment values  
(with end spring)

For emergency stop rope pull switches XY2CE, the adjustment values depend on the positions of the cam located inside the switch. The adjustment is made by rotating the cam after the switch has been installed. Each notched of the cam is referenced by the letters A to F and the selected letter is visible through a viewing port.

The use of an end spring is strongly advised, so you can see the references in the table below regarding each type:

Type	Position of cam	Maximum length of cable	End spring
XY2CH	–	30 meters	XY2CZ703
XY2CE	A, B, C, D, E, F	70 meters	XY2CZ702

XY2CH

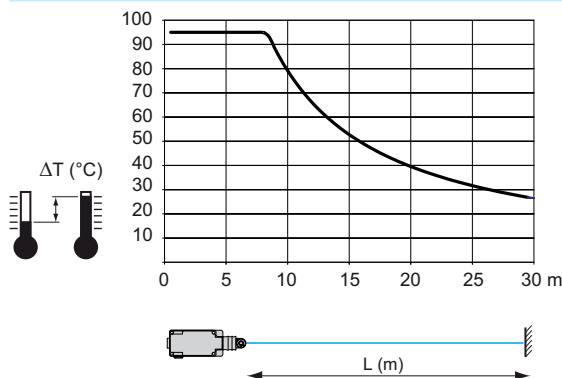

With the graph above, if we consider an ambient temperature variation of 25°C, for example from 0°C to + 25°C, the table gives us a maximum cable length of 30 meters.

XY2CE

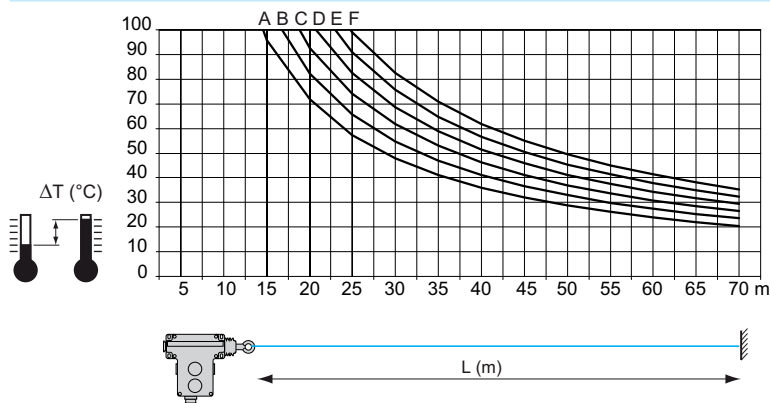

With the graph above, if we consider an ambient temperature variation of 35°C, for example from - 10°C to + 25°C, the table gives us a maximum cable length of :

- 40 meters with cam A adjustments,
- 70 meters with cam F adjustments.

#### Environment

Conformity to standards	Products	<b>XY2CH, XY2CE:</b> EN/IEC 60947-5-5, EN/ISO 13850: 2006, UL 508 and CSA C 22-2 n° 14 (with suffix H7)
	Machine assemblies	<b>XY2CH, XY2CE:</b> EN/IEC 60204-1, Machinery directive: 2006/42/EC, Work equipment directive: 2009/104/EC
Product certifications		<b>XY2CH, XY2CE:</b> UL-CSA (with suffix H7), CCC (1)
Maximum safety level (2)		PL e, category 4 conforming to EN/ISO 13849-1 and SIL CL3 conforming to EN/IEC 62061
Reliability data B <sub>10d</sub>		<b>XY2CH:</b> 4,000,000 <b>XY2CE:</b> 50,000 (data values for a service life of 20 years: can be limited by contact and mechanical wear)
Protective treatment	Standard version	"TC"
	Special version	"TH"
Ambient air temperature	For operation	- 25...+ 70 °C
	For storage	- 40...+ 70 °C
Vibration resistance		<b>XY2CH:</b> 10 gn (10...150 Hz) <b>XY2CE:</b> 10 gn (10...300 Hz) conforming to EN/IEC 60068-2-6
Shock resistance		<b>XY2CH, XY2CE:</b> 50 gn (duration 11 ms) conforming to EN/IEC 60068-2-27
Electric shock protection		Class I conforming to IEC 61140
Degree of protection		<b>XY2CH, XY2CE:</b> IP 65 conforming to IEC 60529 (IP 66 for XY2CE●A1●●, XY2CE●A2●● and XY2CE●A3●●)
Mechanical life		<b>XY2CH:</b> 800,000 operating cycles <b>XY2CE:</b> 10,000 operating cycles
Length of protected zone (rope pull)		<b>XY2CH:</b> ≤ 30 metres, <b>XY2CE:</b> ≤ 70 metres
Distance between cable supports		5 m
Cable entries		<b>XY2CH:</b> tapped entries with Pg 13.5, ISO M20 or 1/2" NPT. <b>XY2CE:</b> plain holes for Pg 13.5, ISO M20 or 1/2" NPT. See dimensions, page 11.

#### Contact block characteristics

Rated operational characteristics	2-pole contacts	<b>XY2CH, XY2CE:</b> AC-15: A300 or U <sub>e</sub> = 240 V, I <sub>e</sub> = 3 A DC-13: Q300 or U <sub>e</sub> = 250 V, I <sub>e</sub> = 0.27 A, conforming to EN/IEC 60947-5-1 Appendix A
	3-pole contacts	<b>XY2CH, XY2CE:</b> AC-15: C300 or U <sub>e</sub> = 240 V, I <sub>e</sub> = 0.75 A DC-13: R300 or U <sub>e</sub> = 250 V, I <sub>e</sub> = 0.1 A, conforming to EN/IEC 60947-5-1 Appendix A
Nominal thermal current		10 A
Rated insulation voltage	2-pole contacts	<b>XY2CH, XY2CE:</b> U <sub>i</sub> = 500 V degree of pollution 3 conforming to EN/IEC 60947-1, U <sub>i</sub> = 300 V conforming to UL 508, CSA C22-2 n° 14
	3-pole contacts	<b>XY2CH, XY2CE:</b> U <sub>i</sub> = 400 V degree of pollution 3 conforming to EN/IEC 60947-1, U <sub>i</sub> = 300 V conforming to UL 508, CSA C22-2 n° 14
Rated impulse withstand voltage	2-pole contacts	<b>XY2CH, XY2CE:</b> U <sub>imp</sub> = 6 kV conforming to EN/IEC 60947-1
	3-pole contacts	<b>XY2CH, XY2CE:</b> U <sub>imp</sub> = 4 kV conforming to EN/IEC 60947-1
Positive operation		NC contact with positive opening operation conforming to EN/IEC 60947-5-1 Section 3
Contact operation		<b>XY2CH, XY2CE</b> (Emergency stop)
Resistance across terminals		≤ 25 mΩ conforming to NF C 93-050 method A or EN/IEC 60255-7 category 3
Terminal referencing		Conforming to CENELEC EN 50013
Short-circuit protection	2-pole contacts	<b>XY2CH, XY2CE:</b> 10 A cartridge fuse type gG (gl) conforming to IEC 60269
	3-pole contacts	<b>XY2CH, XY2CE:</b> 6 A cartridge fuse type gG (gl) conforming to IEC 60269
Rated operational power (Electrical durability)		<b>XY2CH, XY2CE</b> Conforming to EN/IEC 60947-5-1 Appendix C. Utilisation categories AC-15 and DC-13 Operating rate: 3600 operating cycles/hour. Load factor: 0.5

**AC supply** ~ 50/60 Hz  
~ Inductive circuit

#### 2-pole contacts

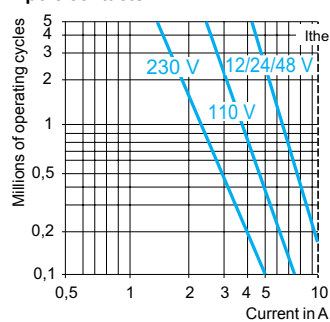

#### 3-pole contacts

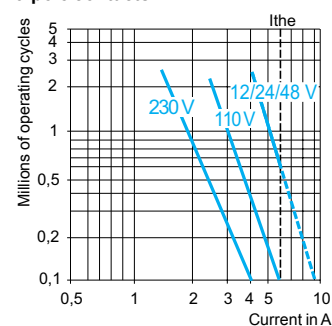

**DC supply** ---  
Power broken in W for 1 million operating cycles  
~ Inductive circuit

Voltage V	24	48	120
Power W	13	9	7

Voltage V	24	48	120
Power W	4	3	2

#### Contact connection

Screw clamp terminals  
Clamping capacity: min. 1 x 0.5 mm<sup>2</sup>, max. 2 x 1.5 mm<sup>2</sup>  
Minimum tightening torque: 0.8 N.m. Maximum tightening torque: 1.2 N.m

- (1) Only products XY2CH without pilot light are CCC and UL-CSA approved.  
(2) Using an appropriate and correctly connected control system.

# Safety detection solutions

## Emergency stop rope pull switches

### Preventa XY2C



XY2CH13250

#### Latching Emergency stops

(Pg 13.5, integrated turnbuckle, cable and end spring to be ordered separately) <sup>(1)</sup>

##### Without pilot light

Length of cable	Colour of enclosure	Reset	Supply voltage	Type of contact	Cable anchor point	Reference	Weight	
							kg	
≤ 30 m	Red RAL 3000 body and stainless steel cover	By booted pushbutton	—	1 1	NC + NO slow break	Both sides (right or left)	XY2CH13250 (3)	0.865
		By mushroom head pushbutton	—	1 1			XY2CH13350 (3)	0.900
		By key operated pushbutton (key n° 421) (2)	—	1 1			XY2CH13450 (3)	0.910
		By flush pushbutton	—	2 —	NC + NC slow break	Both sides (right or left)	XY2CH13170 (3)	0.865
		By booted pushbutton	—	2 —			XY2CH13270 (3)	0.865
		By mushroom head pushbutton	—	2 —			XY2CH13370 (3)	0.865
		By key operated pushbutton (key n° 421) (2)	—	2 —			XY2CH13470 (3)	0.910
		By flush pushbutton	—	2 1	2 NC + 1 NO slow break	Both sides (right or left)	XY2CH13190 (3)	0.865
		By booted pushbutton	—	2 1			XY2CH13290 (3)	0.865
		By mushroom head pushbutton	—	2 1			XY2CH13390 (3)	0.865

##### With pilot light (direct supply)

≤ 30 m	Red RAL 3000 body and stainless steel cover	By booted pushbutton	24 V	1 1	NC + NO slow break	Both sides (right or left)	XY2CH13253	0.900
				2 —	NC + NC slow break		XY2CH13273	0.900
				2 1	2 NC + 1 NO slow break		XY2CH13293 (3)	0.950

#### Latching Emergency stops

(turnbuckle, cable and end spring to be ordered separately) <sup>(1)</sup>

##### Without pilot light

≤ 70 m (4)	Red RAL 3000 body and stainless steel cover	By booted pushbutton	—	1 1	NC + NO slow break	Right side	XY2CE1A250 (5)	1.450
						Left side	XY2CE2A250 (5)	1.450
				2 —	NC + NC slow break	Right side	XY2CE1A270 (5)	1.450
						Left side	XY2CE2A270 (5)	1.450
		By key switch (key n° 421)	—	1 1	NC + NO slow break	Right side	XY2CE1A450 (5)	1.465
						Left side	XY2CE2A450 (5)	1.465
				2 —	NC + NC slow break	Right side	XY2CE1A470 (5)	1.470
						Left side	XY2CE2A470 (5)	1.470

##### With pilot light (direct supply)

≤ 70 m (4)	Red RAL 3000 body and stainless steel cover	By booted pushbutton	24 to 130 V	2 2	NC + NO slow break	Right side	XY2CE1A296	1.470
						Left side	XY2CE2A296	1.470
			230 to 240 V	2 2	NC + NO slow break	Right side	XY2CE1A297	1.470
						Left side	XY2CE2A297	1.470

##### Other versions

See order forms on pages 7 and 8.

**XY2CE** with reset by Ø 40 mm mushroom head pushbutton or with integral cable tensioner and support.

Please consult our Customer Care Centre.

(1) See separate components, page 9.

(2) Ø 30 spring return key operated mushroom head pushbutton.

(3) For ISO M20 threaded cable entry version, add H29 to the end of the reference selected.

Example: XY2CH13250 becomes XY2CH13250H29.

(4) Available with window for viewing cable tension indicator, for adjustment whilst the cover is closed (see versions XY2CE●D●●● and XY2CE●E●●● on the order form, page 8).

(5) ATEX version available (products for explosive atmospheres): To order, add **EX** to the end of the reference.

Example: XY2CE1A250 becomes XY2CE1A250EX.



XY2CH13250

### Complete units, pre-assembled

Customer			Schneider Electric Industries SA	
Company	Order N°	Delivery date	Sales office - Subsidiary Co.	Order N°

**How to use this form:**  
- indicate the number of Emergency stop switches required,  
- complete the basic reference.

### Reference

Number of identical Emergency stops		XY2CH						
<b>Model</b>								
Emergency stop (latching)		1						
<b>Degree of protection</b>								
IP 65 (standard bellows) with integral tensioner		3						
IP 65 (silicone bellows) with integral tensioner		4						
<b>Type of reset</b>								
Emergency stop (1) Reset by spring return pushbutton	Flush	1						
	Booted	2						
	Mushroom head, Ø 30	3						
	Key operated mushroom head, Ø 30 (key n° 421)	4						
	Key operated mushroom head, Ø 30 (key n° 455)	5						
	Key operated mushroom head, Ø 30 (2)	9						
<b>Contact blocks for Emergency stop function (3)</b>								
Slow break	1 NC + 1 NO (NO staggered)	5						
	2 NC	7						
	2 NC + 1 NO	9						
<b>Pilot light</b>								
Without pilot light		0						
With 24 V direct supply pilot light		3						
With 48 V direct supply pilot light		4						
With 130 V direct supply pilot light		5						
With 230 V direct supply pilot light		7						
<b>Tapped cable entry</b>								
1/2" NPT (4)							H7	
ISO M20							H29	
<b>Increased protection</b>								
Treatment against corrosion (5)								TK

(1) Opening of a circuit + mechanical latching in the open position.  
(2) Other key numbers: 458A, 520E, 1242A, 1243E, 1344A, 1422A, 1431E, 2123E and 2132E.  
(3) Emergency stop rope pull switches can only be fitted with slow break contact blocks.  
(4) Only for versions without pilot light. For versions with pilot light, order an H4 version.  
(5) Protective treatment TK is only possible for switches with silicone bellows (XY2CH14●●●TK, XY2CH14●●●H29TK, etc).

**Telemecanique**  
**Sensors**

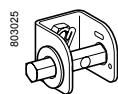

XY2CZ203

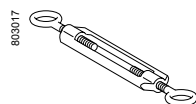

XY2CZ402



XY2CZ503



XY2CZ524



XY2CZ601

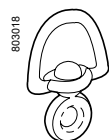

XY2CZ602

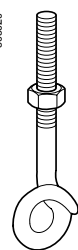

XY2CZ705



XY2CZ708



XY2CZ701

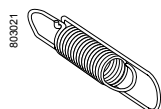

XY2CZ702

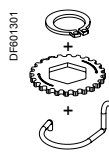

XY2CZ918

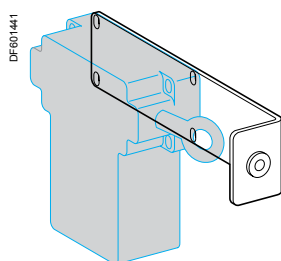

XY2CZ804

### Separate components

Description	For use with	Diameter mm	Length m	Reference	Weight kg
Galvanised cables with red sheath	XY2CH	3.2	10.5	XY2CZ301	0.280
			15.5	XY2CZ3015	0.410
			25.5	XY2CZ302	0.690
			30.5	XY2CZ303	0.830
	XY2CE	5	15.5	XY2CZ1015	0.850
			25.5	XY2CZ102	1.400
			50.5	XY2CZ105	2.750
			70.5	XY2CZ107	3.870

Description	Type	For use with	Sold in lots of	Unit reference	Weight kg
Tensioner	—	XY2CE	1	XY2CZ203	0.090
Turnbuckles	M6 x 60 + locknut	All models (1)	1	XY2CZ402	0.060
	M8 x 70 + locknut	All models (1)	1	XY2CZ404	0.100
Cable grips	Single	Cable Ø 3 to 5 mm	10	XY2CZ503	0.007
	Double	Cable Ø 3 to 5 mm	10	XY2CZ513	0.016
	Clamp	Cable Ø 3.2 mm	10	XY2CZ523	0.050
		Cable Ø 5 mm	10	XY2CZ524	0.080
Cable supports	Fixed	All models	10	XY2CZ601	0.030
	Swivelling	All models	1	XY2CZ602	0.130
	Pulley support	All models	1	XY2CZ705	0.060
Pulley	Cable Ø 5 mm max.	XY2CH and XY2CE	1	XY2CZ708	0.002
Cable end protectors	—	Cable Ø 3.2 mm	10	XY2CZ701	0.002
		Cable Ø 5 mm	10	XY2CZ704	0.010
End springs	—	XY2CH	1	XY2CZ703	0.035
		XY2CE	1	XY2CZ702	0.080

### Mounting accessories and kits

Contents	For use with	Cable diameter mm	Length of cable m	Reference	Weight kg
Bracket	XY2CE	—	—	XY2CZ804	0.474
1 spring tensioner + 1 notched washer + 1 circlip	XY2CH	—	—	XY2CZ918	0.010
1 galvanised cable + 1 cable grip XY2CZ523 + 1 end spring XY2CZ703	XY2CH	3.2	10	XY2CZ9310	0.415
			15	XY2CZ9315	0.535
			30	XY2CZ9330	0.915
1 galvanised cable + 4 cable grips XY2CZ524 + 1 turnbuckle XY2CZ404. + 1 cable support XY2CZ601 + 3 cable end protectors XY2CZ704 + 1 end spring XY2CZ702.	XY2CE	5	25	XY2CZ9525	1.905
			50	XY2CZ9550	3.280
			70	XY2CZ9570	4.000

(1) Emergency stop rope pull switches XY2CH13●●● and XY2CH14●●● incorporate a cable tensioner as standard. Therefore, there is no need to order a turnbuckle.

## Replacement parts

Description	For use with	Type	Reference	Weight kg	
Reset pushbutton (blue), spring return	XY2CH	Flush with “R” marked on push	<b>ZB5AA639</b>	0.018	
		Booted	<b>ZB5AP6</b>	0.019	
		Mushroom head, Ø 30	<b>ZB5AC64</b>	0.027	
	XY2CE	Flush with “R” marked on push	<b>ZB5AA639</b>	0.018	
		Booted	<b>ZB5AP6S</b>	0.021	
		Mushroom head, Ø 30	<b>ZB5AC64</b>	0.027	
Key switch	XY2CH and XY2CE	With key n° 421	<b>ZB5AG612R26</b>	0.064	
		With key n° 455	<b>ZB5AG6R26</b>	0.064	
Keys for reset button	All types of Emergency stop	N° 421	<b>Q99900911</b>	0.006	
		N° 455	<b>Q99900901</b>	0.006	
Pilot light head assembly	XY2CE	Red	<b>XY2CZ800</b>	0.015	
		Orange	<b>XY2CZ801</b>	0.015	
Set of 5 cover gaskets	XY2CE	–	<b>XY2CZ805</b>	0.122	
Fixing nut, plastic, grey	XY2CH and XY2CE	–	<b>ZB5AZ901</b>	0.002	
Fixing nut tightening key, plastic, grey	XY2CH and XY2CE For fixing nut ZB5AZ901		<b>ZB5AZ905</b>	0.016	
Description	For use with	Voltage	Sold in lots of	Unit reference	Weight kg
Pilot lights With bulb DL1AA●●● included	XY2CH Colour: orange	24 V	1	<b>XY2CZ0024 (1)</b>	0.035
		130 V	1	<b>XY2CZ0130 (1)</b>	0.035
		230 V	1	<b>XY2CZ0230 (1)</b>	0.035
Supply on LED	XY2CE Colour: red	24 V	1	<b>ZALVB4</b>	0.015
		130 V	1	<b>ZALVG4</b>	0.015
		230 to 240 V	1	<b>ZALVM4</b>	0.015
	XY2CE Colour: orange	24 V	1	<b>ZALVB5</b>	0.015
		130 V	1	<b>ZALVG5</b>	0.015
		230 to 240 V	1	<b>ZALVM5</b>	0.015
Incandescent bulbs, screw base fitting	XY2CH	24 V - 6 W	10	<b>DL1AA024</b>	0.004
		130 V - 6 W	10	<b>DL1AA127</b>	0.004
		230 V - 6 W	10	<b>DL1AA220</b>	0.004
Set of 5 collars	For mounting DL1AA127 and DL1AA220 bulbs in pilot lights XY2CZ●●●	–	5	<b>XY2CZ908</b>	0.018

(1) Only for use as replacement parts for switches pre-fitted with pilot lights. CCC and UL-CSA approvals no longer apply if an XY2CZ●●● pilot light is mounted on Emergency stops XY2CH.

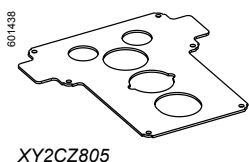

XY2CZ805

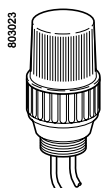

XY2CZ●●●

#### Latching Emergency stops

##### XY2CH

###### Without pilot light

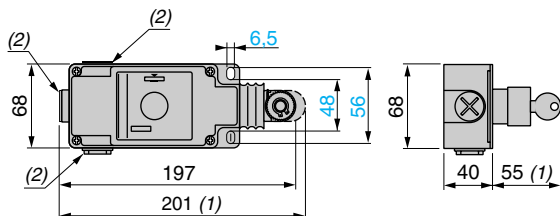

###### With pilot light

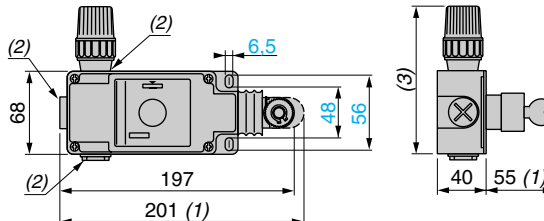

(1) Maximum extension.

(2) Tapped entries for n° 13 (Pg 13.5) cable gland. For ISO M20 the reference becomes **XY2CH●●●●●H29**.

(3) 121 mm: 24 V and 48 V versions. 131 mm: 130 V and 230 V versions.

##### XY2CE

###### XY2CE1A●●● (anchor point on right side)

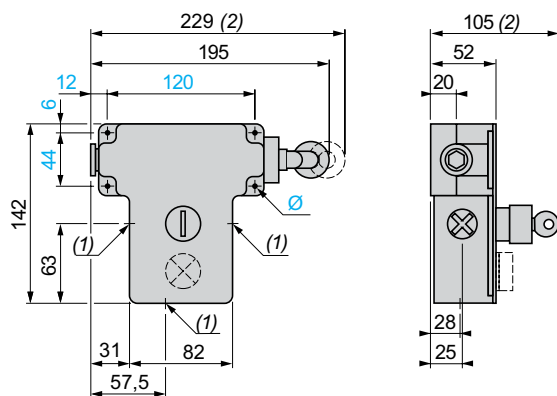

###### XY2CE●A●●● + XY2CZ804 bracket

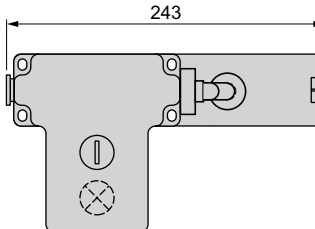

#### Accessories

##### XY2CZ705

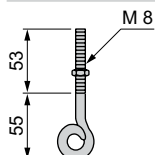

##### XY2CZ708

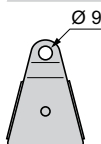

(1) 3 plain holes for n° 13 (Pg 13.5) or ISO M20 cable gland.

(2) Maximum extension.

Ø: 4 elongated holes Ø 6 mm.

Environment																											
Conformity to standards	Products	EN/IEC 60947-5-1, CSA C 22-2 n° 14 (with suffix H2)																									
Product certifications		CSAA 600-Q 600 (with suffix H2)																									
Protective treatment	Standard version	"TC"																									
	Special version	"TH"																									
Ambient air temperature	For operation	- 25...+ 70 °C																									
	For storage	- 40...+ 70 °C																									
Electric shock protection		Class I conforming to IEC 61140																									
Degree of protection		Enclosure: IP 22, contact housing: IP 65, conforming to IEC 60529																									
Mechanical life		10,000 operating cycles																									
Length of protected zone		≤ 100 metres and ≤ 2 x 100 metres																									
Distance between cable supports		5 m																									
Cable entries		See dimensions, page 15.																									
Contact block characteristics																											
Rated operational characteristics		AC-15: A 600 or Ue = 600 V, Ie = 1.2 A DC-13: Q 600 or Ue = 600 V, Ie = 0.1 A, conforming to EN/IEC 60947-5-1 Appendix A																									
Nominal thermal current		10 A																									
Rated insulation voltage		Ui = 500 V degree of pollution 3 conforming to EN/IEC 60947-1, Ui = 600 V conforming to CSAC22-2 n° 14																									
Rated impulse withstand voltage		Uimp = 6 kV conforming to EN/IEC 60947-1																									
Positive operation		NC contact with positive opening operation conforming to EN/IEC 60947-5-1 Section 3																									
Contact operation		"NC + NC" or "NC + NO" slow break																									
Resistance across terminals		≤ 25 mΩ conforming to NF C 93-050 method A or EN/IEC 60255-7 category 3																									
Terminal referencing		Conforming to CENELEC EN 50013																									
Short-circuit protection		10 A cartridge fuse type gG (gl) conforming to IEC 60269																									
Rated operational power (Electrical durability)		Conforming to EN/IEC 60947-5-1 Appendix C Utilisation categories AC-15 and DC-13																									
Operating rate: 3600 operating cycles/hour Load factor: 0,5		<div><div>AC supply ~ 50...60 Hz</div><div>Power broken in VA (1)</div><div>Inductive circuit</div><table><tr><td>Voltage</td><td>V</td><td>24</td><td>48</td><td>127</td><td>220</td></tr><tr><td>mm</td><td>VA</td><td>250</td><td>250</td><td>500</td><td>500</td></tr></table></div> <div><div>DC supply ---</div><div>Power broken in W (1)</div><div>Inductive circuit</div><table><tr><td>Voltage</td><td>V</td><td>24</td><td>48</td><td>120</td></tr><tr><td>mm</td><td>W</td><td>50</td><td>100</td><td>100</td></tr></table></div>				Voltage	V	24	48	127	220	mm	VA	250	250	500	500	Voltage	V	24	48	120	mm	W	50	100	100
Voltage	V	24	48	127	220																						
mm	VA	250	250	500	500																						
Voltage	V	24	48	120																							
mm	W	50	100	100																							
Contact connection		Screw clamp terminals Clamping capacity: min. 1 x 0.5 mm², max. 2 x 1.5 mm² Minimum tightening torque: 0.8 N.m Maximum tightening torque: 1.2 N.m																									

(1) For 1 million operating cycles.

### Rope pull switches

(End spring, turnbuckle and cable to be ordered separately) (1)

#### Without pilot light

Length of cable	Colour of enclosure	Reset	Type of contact	Cable anchor point	Reference	Weight
						kg
≤ 100 m	Blue	From inside enclosure	1 1	Left side	<b>XY2CB10</b> (2)	18.750
				Right side	<b>XY2CB20</b> (2)	18.750
			2 -	Left side	<b>XY2CB104</b>	18.750
				Right side	<b>XY2CB204</b>	18.750
≤ 2 x 100 m	Blue	From inside enclosure	1 1	Both sides (right or left)	<b>XY2CB30</b> (2)	29.250
				Both sides (right or left)	<b>XY2CB304</b>	29.250

#### With pilot light

Length of cable	Colour of enclosure	Reset	Supply voltage	Type of contact	Cable anchor point	Reference	Weight	
							kg	
■ Direct supply								
≤ 100 m	Blue	From inside enclosure	24 V	1 1	"NC + NO" slow break	Left side	XY2CB11	19.550
						Right side	XY2CB21	19.550
			48 V	1 1	"NC + NO" slow break	Left side	XY2CB12	19.550
						Right side	XY2CB22	19.550
≤ 2 x 100 m	Blue	From inside enclosure	24 V	1 1	"NC + NO" slow break	Both sides (right or left)	XY2CB31	25.600
						Both sides (right or left)	XY2CB32	30.050
			48 V	1 1	"NC + NO" slow break	Both sides (right or left)	XY2CB32	30.050
						■ Supply via integral transformer (3)		
≤ 100 m	Blue	From inside enclosure	127 V/6 V	1 1	"NC + NO" slow break	Left side	XY2CB13	15.600
						Right side	XY2CB23	15.600
			220 V/6 V	1 1	"NC + NO" slow break	Left side	XY2CB14	15.600
						Right side	XY2CB24	15.600
≤ 2 x 100 m	Blue	From inside enclosure	127 V/6 V	1 1	"NC + NO" slow break	Both sides (right or left)	XY2CB33	25.600
						Both sides (right or left)	XY2CB34	25.600
			220 V/6 V	1 1	"NC + NO" slow break	Both sides (right or left)	XY2CB34	25.600

(1) See separate components, page 4.

(2) For 1/2" NPT threaded cable entry version, add the suffix H2 to the reference selected.

Example: **XY2CB10** becomes **XY2CB10H2**.

(3) Bulb **DL1CB006** included.



XY2CB30

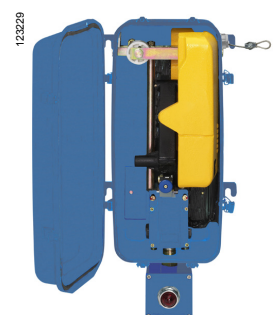

XY2CB21

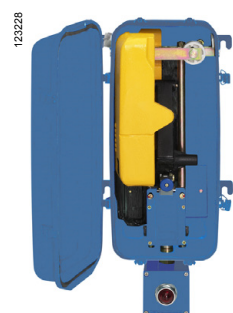

XY2CB13

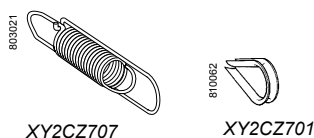
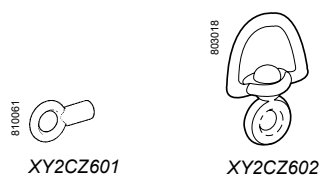

### Separate components and replacement parts

Description	Diameter mm	Length m	Reference	Weight kg
Galvanised cables with red sheath	3.2	10.5	XY2CZ301	0.280
		15.5	XY2CZ3015	0.410
		25.5	XY2CZ302	0.690
		50.5	XY2CZ305	1.360
		100.5	XY2CZ310	2.700

Description	Type	Sold in lots of	Unit reference	Weight kg
Turnbuckles	M6 x 60 + locknut	1	XY2CZ402	0.060
	M8 x 70 + locknut	1	XY2CZ404	0.100
Cable grips for cables Ø 3 to 5 mm	Simple	10	XY2CZ503	0.007
	Double	10	XY2CZ513	0.016
Cable grips for cables Ø 3.2 mm	Clamp	10	XY2CZ523	0.050
Cable supports	Fixed	10	XY2CZ601	0.030
	Swivelling	1	XY2CZ602	0.130
Pulley support	—	1	XY2CZ705	0.060
Cable end protectors for cables Ø 3.2 mm	—	10	XY2CZ701	0.002
End spring	—	1	XY2CZ707	0.314

Description	Voltage	Sold in lots of	Unit reference	Weight kg
Pilot lights With bulb DL1AA●●● included	24 V	1	9001KP35R9	0.134
	120 V	1	9001KP1R9	0.210
	230 V	1	9001KP7R9	0.210
Incandescent bulbs, BA 9s base fitting	24 V - 2.6 W	10	DL1CE024	0.002
	6 V - 1.2 W	10	DL1CB006 (1)	0.002
ISO M20 adaptor	—	5	DE9RP13520	0.050

(1) For use with XY2CB, 120 V and 230 V.

## Dimensions

### XY2CB

#### Without pilot light

#### With pilot light

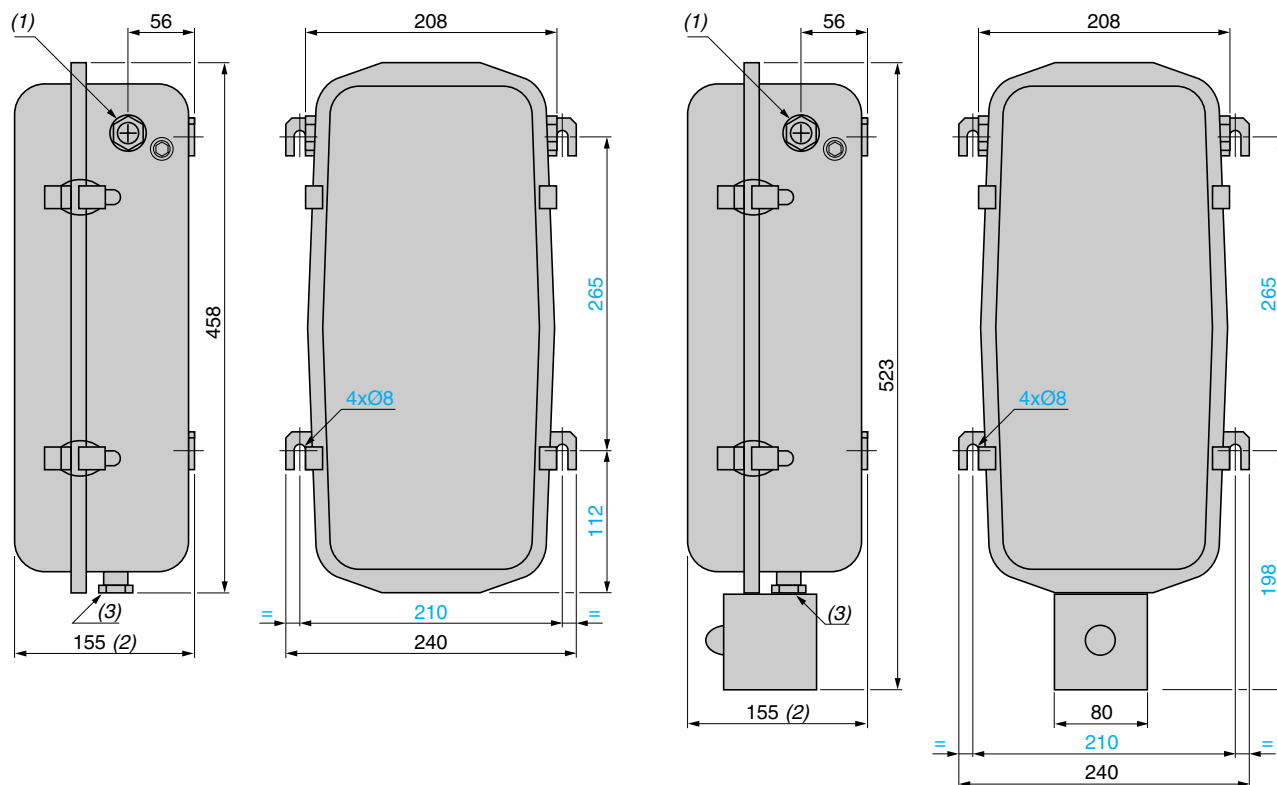

(1) 2 access points for operating cable.

(2) + 125 for opening cover.

(3) 1 tapped entry for n° 13 (Pg 13.5) cable gland. For ISO M20 use adaptor **DE9RP13520**.

9001KP1R9	14	XY2CH13290	6	XY2CZ9550	9
9001KP7R9	14	XY2CH13293	6	XY2CZ9570	9
9001KP35R9	14	XY2CH13350	6		
		XY2CH13370	6		
		XY2CH13390	6		
		XY2CH13450	6		
		XY2CZ0024	10		
		XY2CZ102	9		
		XY2CZ105	9		
		XY2CZ107	9		
		XY2CZ0130	10		
		XY2CZ203	9		
		XY2CZ0230	10		
		XY2CZ301	9		
			14		
		XY2CZ302	9		
			14		
		XY2CZ303	9		
		XY2CZ305	14		
		XY2CZ310	14		
		XY2CZ402	9		
			14		
		XY2CZ404	9		
			14		
		XY2CZ503	9		
			14		
		XY2CZ513	9		
			14		
		XY2CZ523	9		
			14		
		XY2CZ524	9		
		XY2CZ601	9		
			14		
		XY2CZ602	9		
			14		
		XY2CZ701	9		
			14		
		XY2CZ703	9		
		XY2CZ704	9		
		XY2CZ705	9		
			14		
		XY2CZ707	14		
		XY2CZ708	9		
		XY2CZ800	10		
		XY2CZ801	10		
		XY2CZ804	9		
		XY2CZ805	10		
		XY2CZ908	10		
		XY2CZ918	9		
		XY2CZ1015	9		
		XY2CZ3015	9		
			14		
		XY2CZ9310	9		
		XY2CZ9315	9		
		XY2CZ9330	9		
		XY2CZ9525	9		

<b>Z</b>	
ZALVB4	10
ZALVB5	10
ZALVG4	10
ZALVG5	10
ZALVM4	10
ZALVM5	10
ZB5AA639	10
ZB5AC64	10
ZB5AG6R26	10
ZB5AG612R26	10
ZB5AP6	10
ZB5AP6S	10
ZB5AZ901	10
ZB5AZ905	10



**Schneider Electric Industries SAS**

[www.tesensors.com](http://www.tesensors.com)

Head Office  
35, rue Joseph Monier  
F-92500 Reuil-Malmaison  
France

The information provided in this documentation contains general descriptions and/or technical characteristics of the performance of the products contained herein. This documentation is not intended as a substitute for and is not to be used for determining suitability or reliability of these products for specific user applications. It is the duty of any such user or integrator to perform the appropriate and complete risk analysis, evaluation and testing of the products with respect to the relevant specific application or use thereof. Neither Schneider Electric nor any of its affiliates or subsidiaries shall be responsible or liable for misuse of the information contained herein.

Design: Schneider Electric  
Photos: Schneider Electric