

# DHC Digital Timer



## Application

Plastic, rubber, equipment	Semiconductor electronic components industry	Food related industry
Injection molding machinery Extruding machinery Mold temperature controllers Vacuum forming Blow molding (Thermo foaming)	Preheater Cleaning equipment Mold equipment Bonding machine Diffusion equipment	Refrigerating machine (General, for fishing vessel) Dryer Humidifier Bakery, confectionery equipment
Electric furnaces	Pottery manufacturing Ceramic and Glass industry	Packing machine industry
Baking furnace Heavy oil, gas furnaces Incinerator Aluminum, tin, lead, zinc melting furnace Vacuum furnace	Ceramic industry Glass industry Porcelain enameling Grind stone manufacturing	Bag-making machinery Filling packing machinery Hot blast sealing Shrinking packing machinery

# Features

1. Digital Setting precisely.
2. High value LCD display for clear and obviously monitor.
3. Power failure memory function.
4. Panel Size: DIN ( 48x48mm )
5. LCD Display (DHC6A/DHC8); LED Display (DHC6B)

# Panel Function

## DHC6A

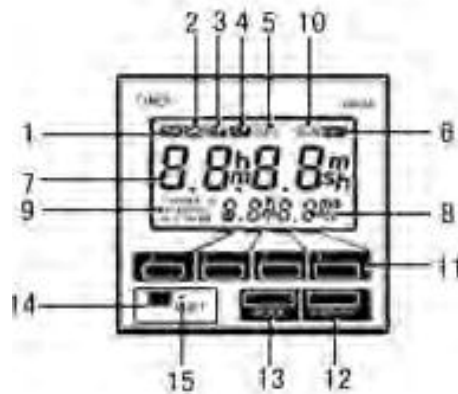

MARKS/DESCRIPTIONDESCRIPTION			
1	Power (PW)	9	Mode Point
2	Signal Input (SIG)	10	RUN Point
3	Reset Input (RST)	11	Set Key
4	Gate Input (GT)	12	Display Key
5	Key Protection (K/P)	13	MODE Key
6	Output (OUT)	14	Reset Key
7	Process Value	15	System Reset Key
8	Set Value		

## DHC6B

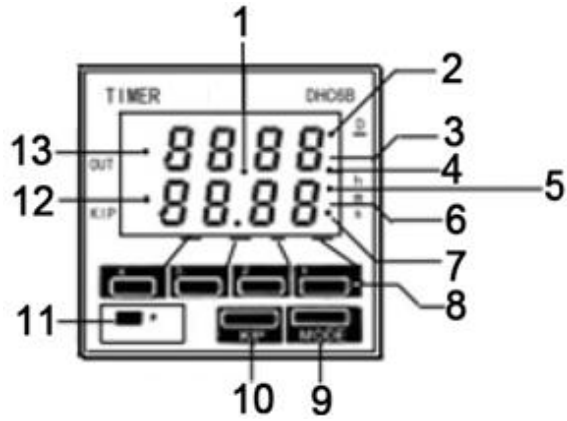

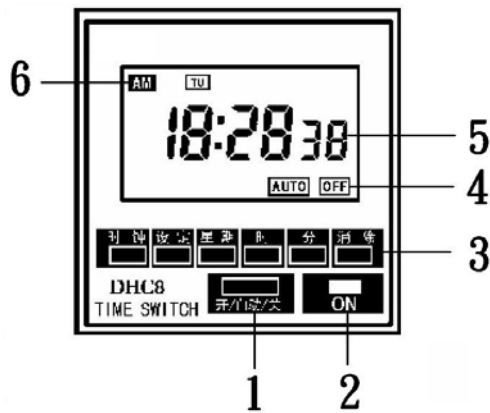

MARKS/DESCRIPTIONDESCRIPTION			
1	Run Point	8	Set Key
2	Down MODE Point	9	MODE Key
3	Process Value	10	K/P Key
4	Hour	11	Reset Key
5	Min	12	K/P Point
6	Set Value	13	OUT Point
7	Sec		

## DHC8



MARKS/DESCRIPTIONDESCRIPTION			
1	Program Execution	4	Program RUN Point
2	RUN Point	5	Set Value
3	Set Key	6	Time indicator

# Standard Specification

Model		DHC6A	DHC6B	DHC8
Products				
Dimension		48H×48W×96D	48H×48W×96D	48H×48W×96D
Mounting & Socket	Surface(-N)	P2CF-08	P2CF-08	P2CF-08
	Flush(-Y)	Y48 & P3G-08 or Y48 & US08	Y48 & P3G-08 or Y48 & US08	Y48 & P3G-08 or Y48 & US08
Full Timing Range		0.01(S)~999.9(H)	0.01(S)~99(H)99(M)	9 programs per day or week
Rated Voltage		AC(V): 220V 50/60Hz 380, 440, 50/60Hz	AC 220V 50/60Hz	AC 220V 50/60Hz
Contact	Time Limit 1C	3A/AC 250V	3A/ AC 250V	16A/AC 250V
	Time Limit 1C	×	×	×
	Instantaneous 1C	×	×	×
Mechanical Life		$>10^7$ TIMES	$>10^7$ TIMES	$>10^7$ TIMES
Electrical Life		$10^5$ TIMES	$>10^5$ TIMES	$>10^5$ TIMES
Accuracy	Repeat Error	$<0.3\% \pm 0.5$ SEC	$<0.3\% \pm 0.05$ SEC	$<1$ SEC / 04Y
	Setting Error	0	0	0
	Voltage Error	$\pm 0.5\%$ MAX	$\pm 0.5\%$ MAX	$\pm 0.5\%$ MAX
	Temp Error	$\pm 2\%$ MAX	$\pm 0.2\%$ MAX	$\pm 0.2\%$ MAX
Resetting Time		0.1 SEC MAX	0.1 SEC MAX	0.1 SEC MAX
Consumed Power		2VA	2VA	2VA
Ambient Temperature		-10°C ~+50°C	-10°C ~+50°C	-10°C ~+50°C
Ambient Humidity		45~85% RH	45~85% RH	45~85% RH
Weight		220g	210g	220g

# External Dimension

DHC6A、DHC6B

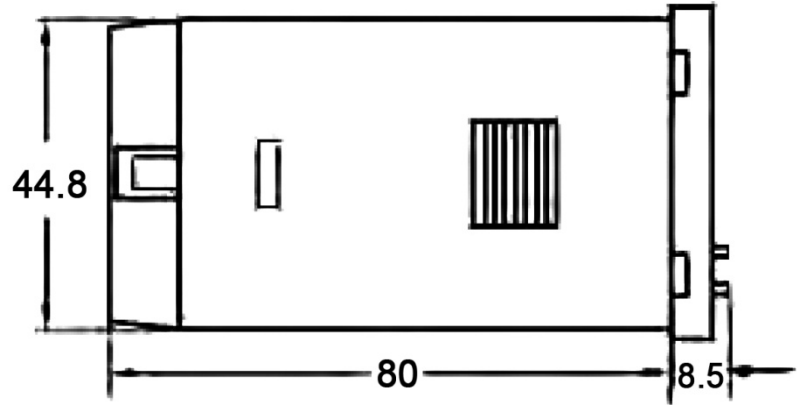
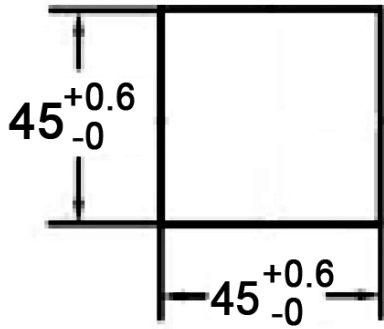

DHC8

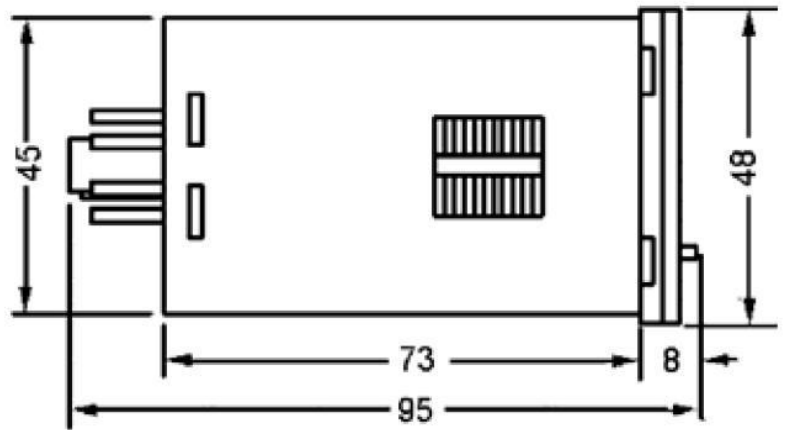
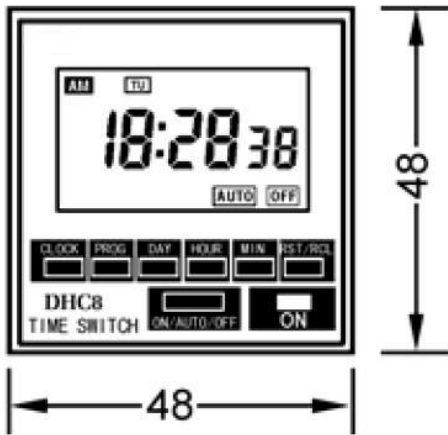

# Socket & Wiring Diagram

## P2CF-08

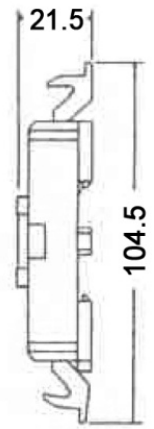
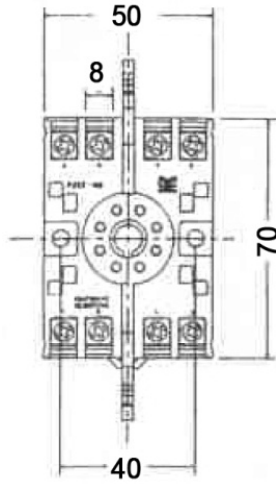

## P3G-08

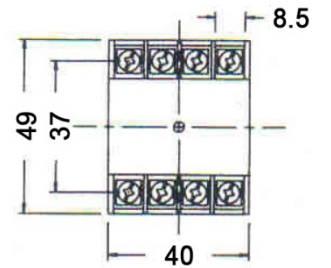
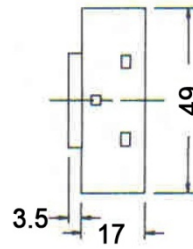
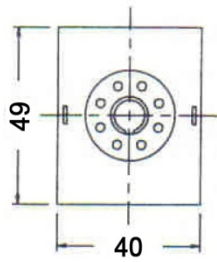
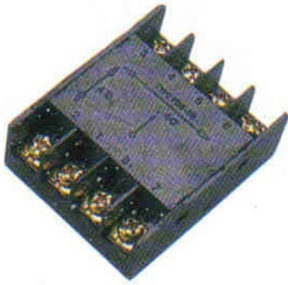

## US08

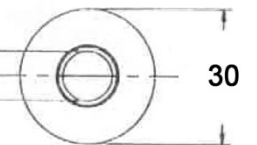
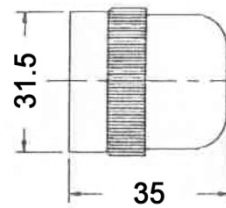
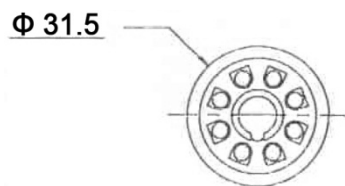

### DHC6A

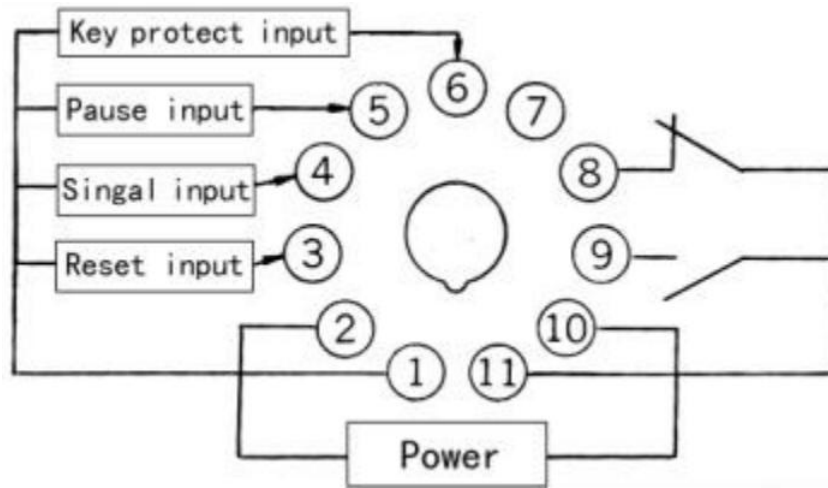

### DHC6B

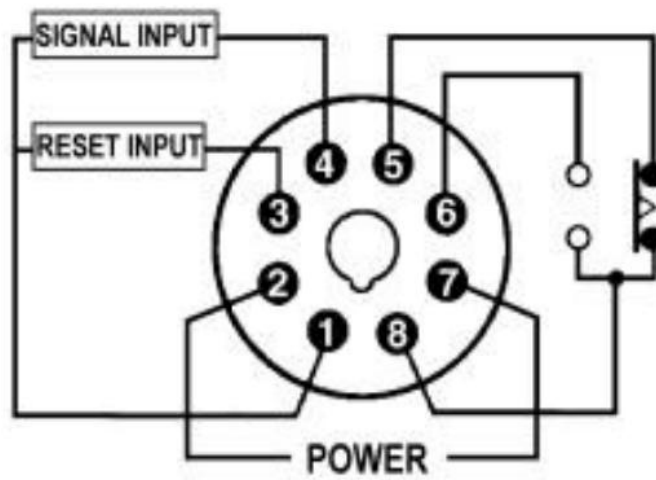

### DHC8

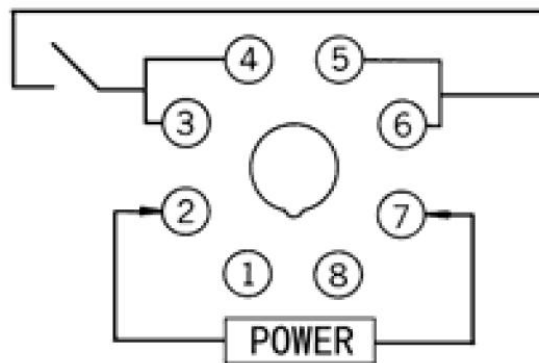

# Contact

## Taipei World Trade Center

Add: 3C22-23 & 3C25-26, Taipei World Trade Center, No. 5, Sec. 5, Hsin Yi Rd. Taipei Taiwan, R.O.C.

Tel: 886-2-27206601 (Rep.)

Fax: 886-2-23455120

E-mail: [gitta@ms9.hinet.net](mailto:gitta@ms9.hinet.net)

<http://www.maxthermo.com>

## Factory

Add: 11F., No.168, Jiankang Rd., Zhonghe Dist., New Taipei City 235, Taiwan (R.O.C.)

Tel: 886-2-22287950 (Rep.)

Fax: 886-2-22286140

## Thailand Office - THAI MAXIMUM ELECTRONIC CO., LTD

Add: 86/132-133 m.7 Samaedum Bangkoontien Bangkok 10150 Thailand.

Tel: +662-415-8318 , +662-417-2548-49

Fax: +662-415-8798

<http://www.thaimaximum.com>